

Xrline

Step 1. Attach side together using sliding door backside; attach front top column flush to top of columns; attach front bottom column.

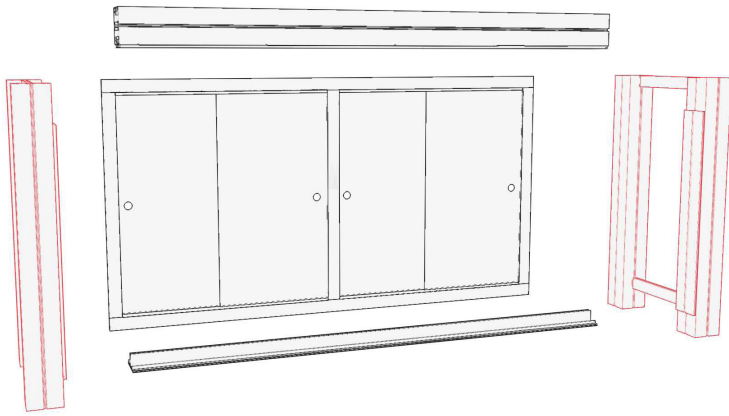

// CrossBar Detail //

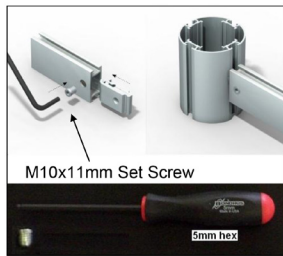

//Column Details\\

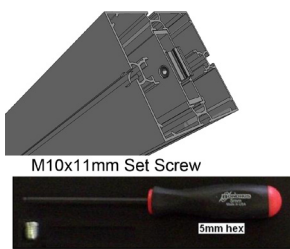

Step 2. Attach lightblocker & front graphic.

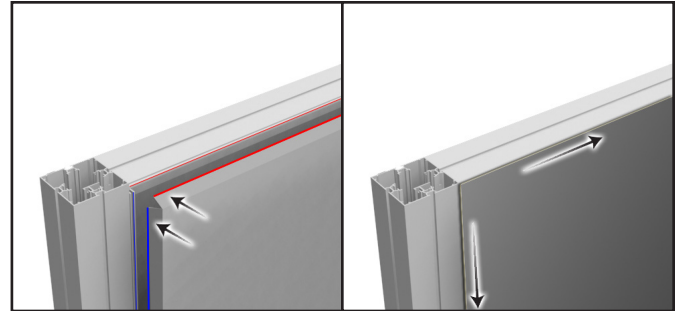
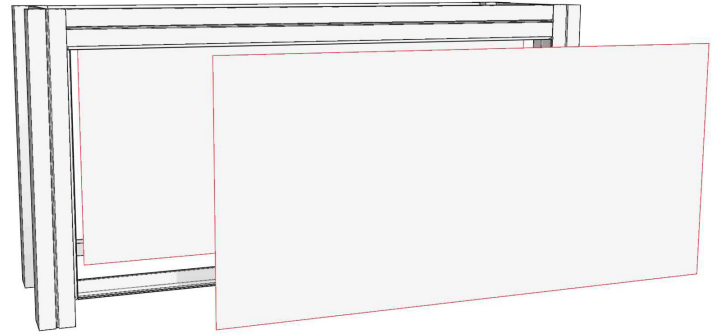

Step 3. Drop shelf onto bottom columns.

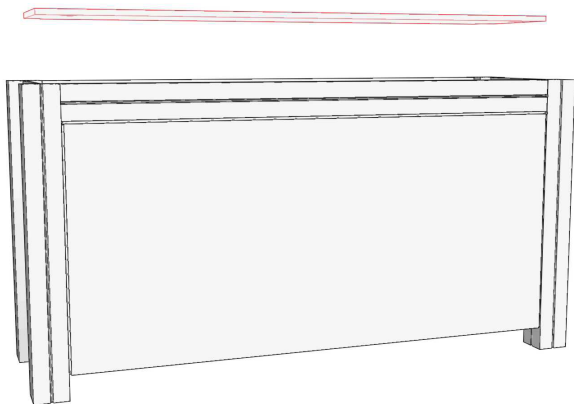

Step 4. Attach insert blocks to counter top; Slide insert blocks down into corner columns.

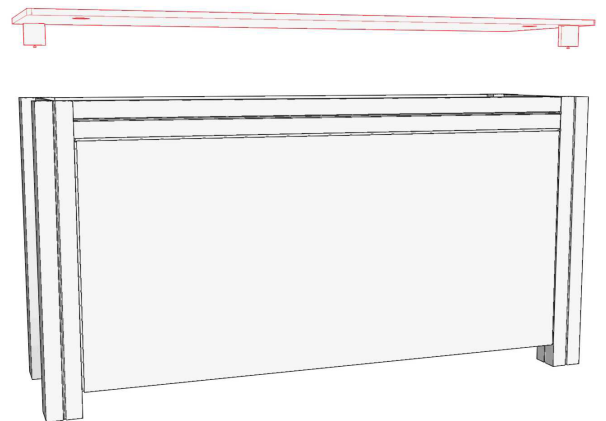

Step 5. Attach side panels to columns using magnet strips.

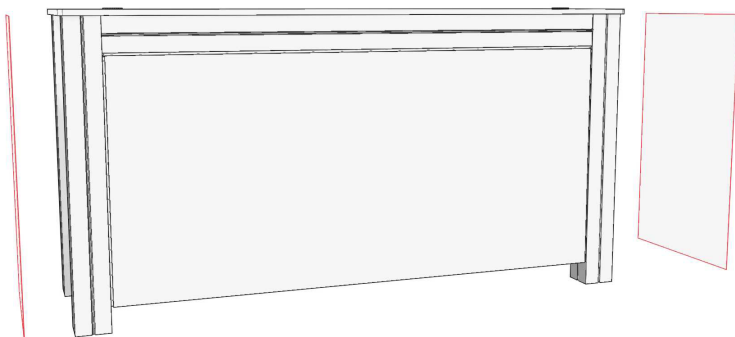

COMPLETE

