

Bracket Detail

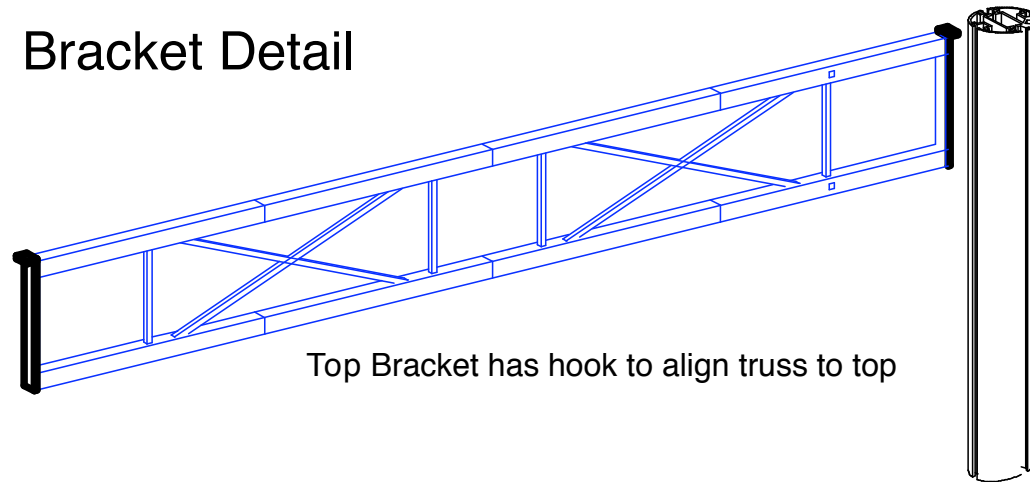

Top Bracket has hook to align truss to top

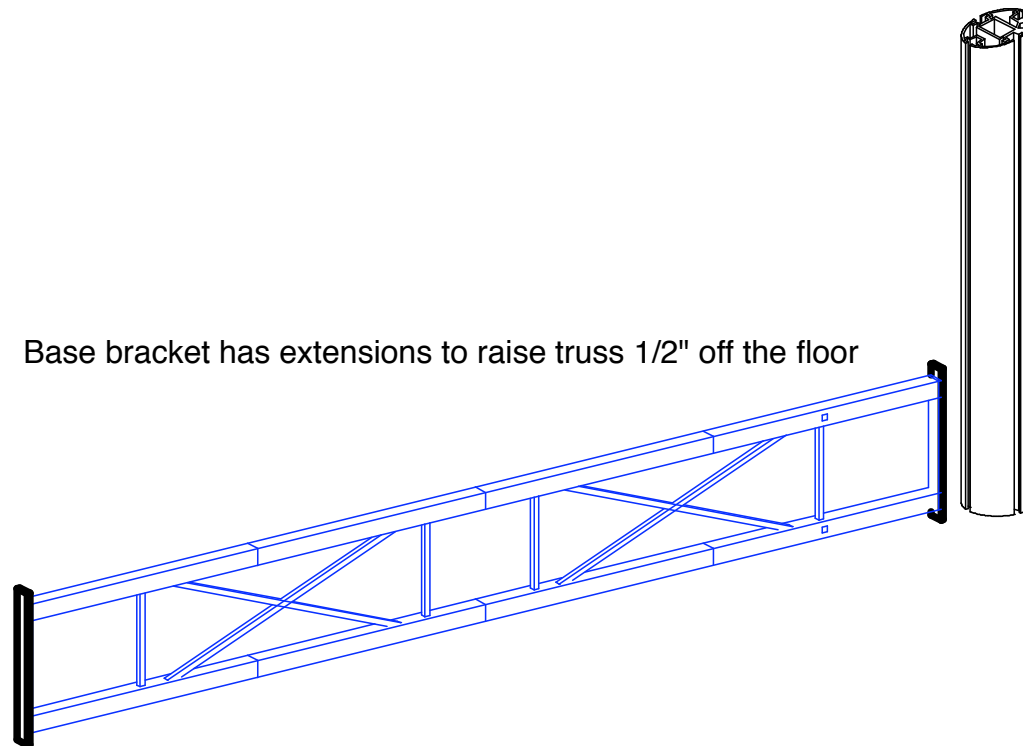

Base bracket has extensions to raise truss 1/2" off the floor



DESIGN :

DATE:

REFERENCE:

© Trussworks 2009

The designs shown herein are the proprietary property of Trussworks and protected by copyright and other laws. This document is to be maintained in confidence. No portion of the information or design shown herein may be reproduced, electronically or otherwise, nor may any display be made from this design without written consent from Trussworks.

DRAWN BY: C.J.Morita

Step 1

This is NOT your layout, the layout below is for demonstration purposes only
Please see attached master sheet for your layout

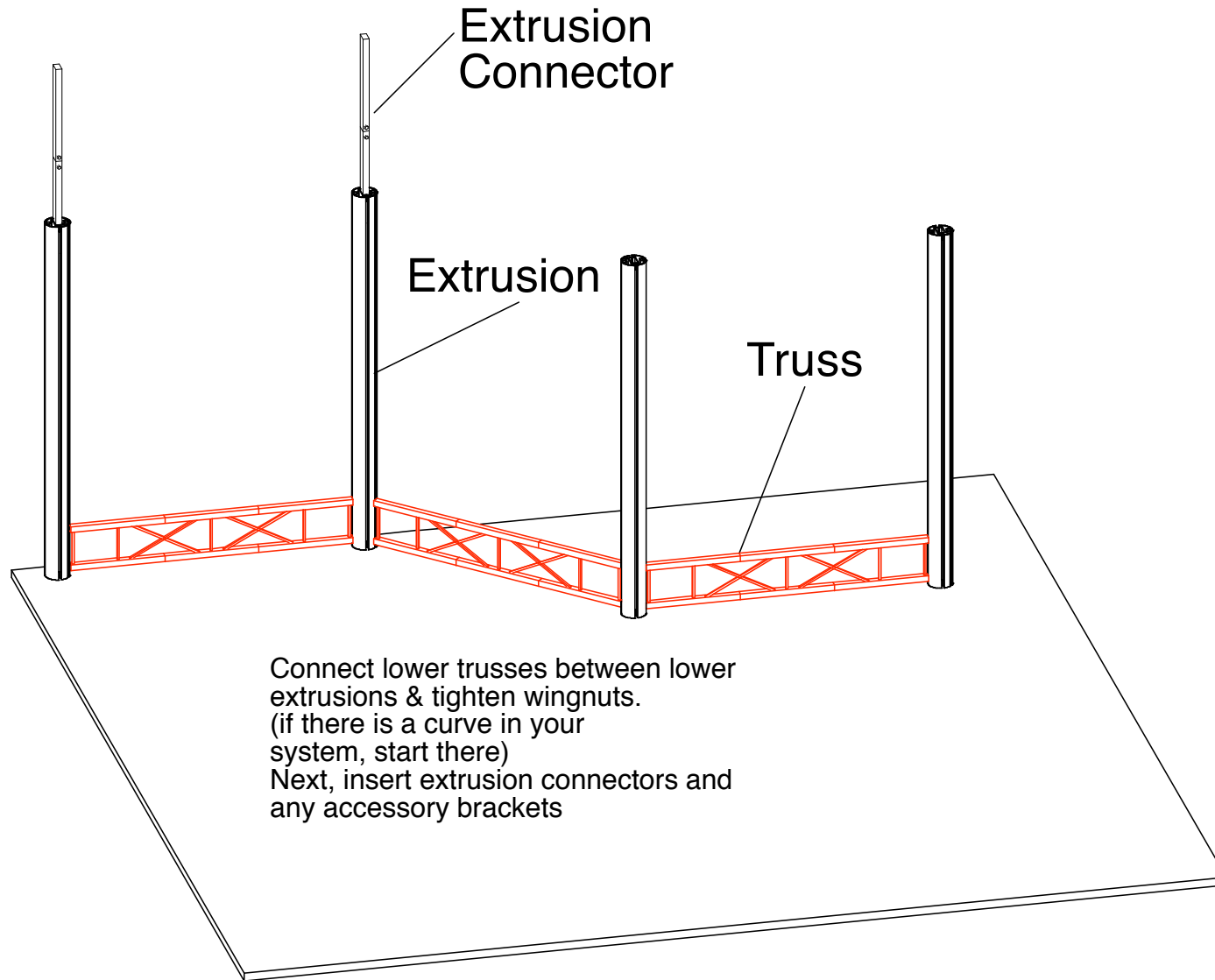

DESIGN :

DATE:

REFERENCE:

© Trussworks 2009

The designs shown herein are the proprietary property of Trussworks and protected by copyright and other laws. This document is to be maintained in confidence. No portion of the information or design shown herein may be reproduced, electronically or otherwise, nor may any display be made from this design without written consent from Trussworks.

DRAWN BY: C.J.Morita

This is NOT your layout, the layout below is for demonstration purposes only
Please see attached master sheet for your layout

Step 2

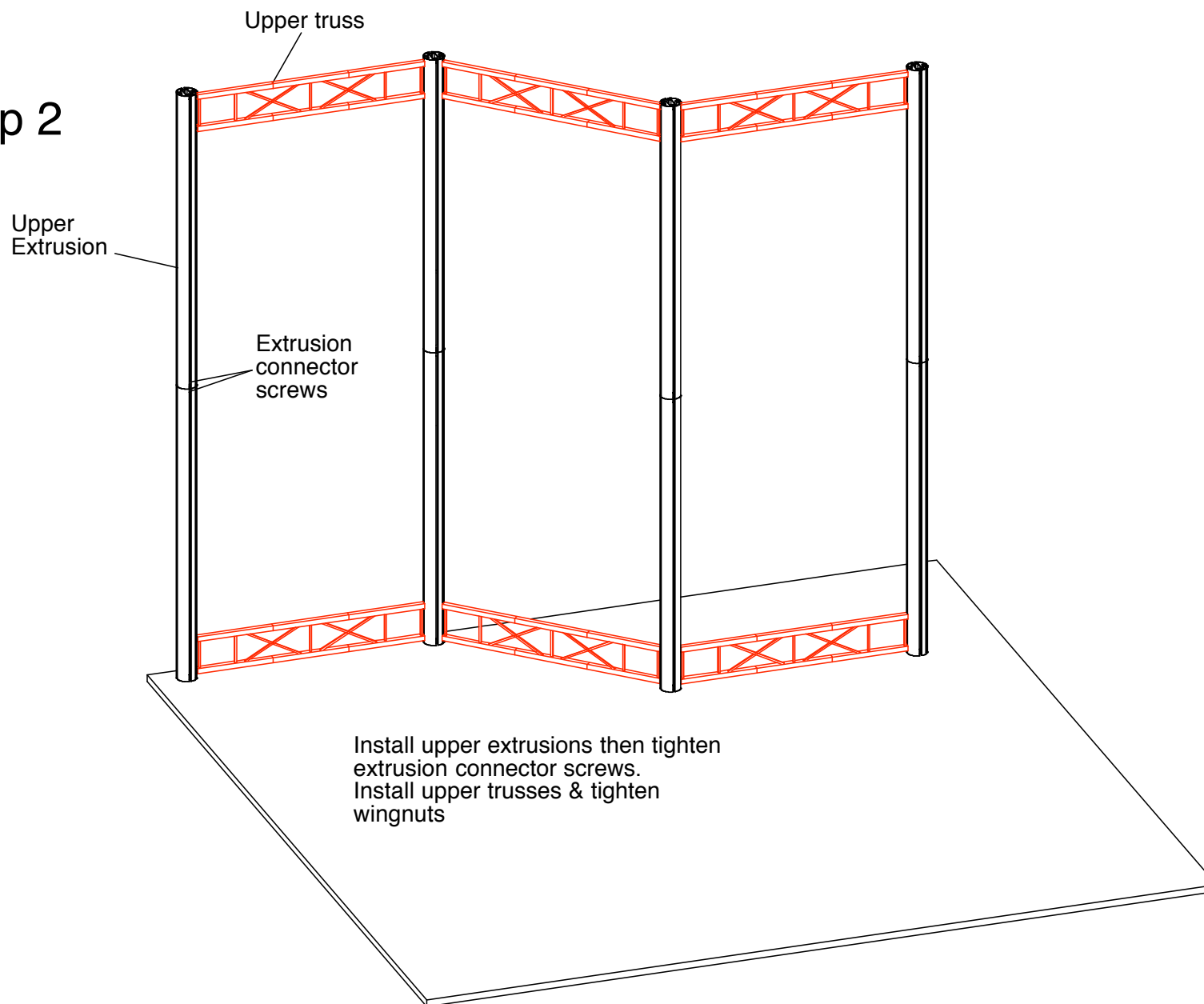

DESIGN :

DATE:

REFERENCE:

© Trussworks 2009

The designs shown herein are the proprietary property of Trussworks and protected by copyright and other laws. This document is to be maintained in confidence. No portion of the information or design shown herein may be reproduced, electronically or otherwise, nor may any display be made from this design without written consent from Trussworks.

DRAWN BY: C.J.Morita

This is NOT your layout, the layout below is for demonstration purposes only
Please see attached master sheet for your layout

Step 3

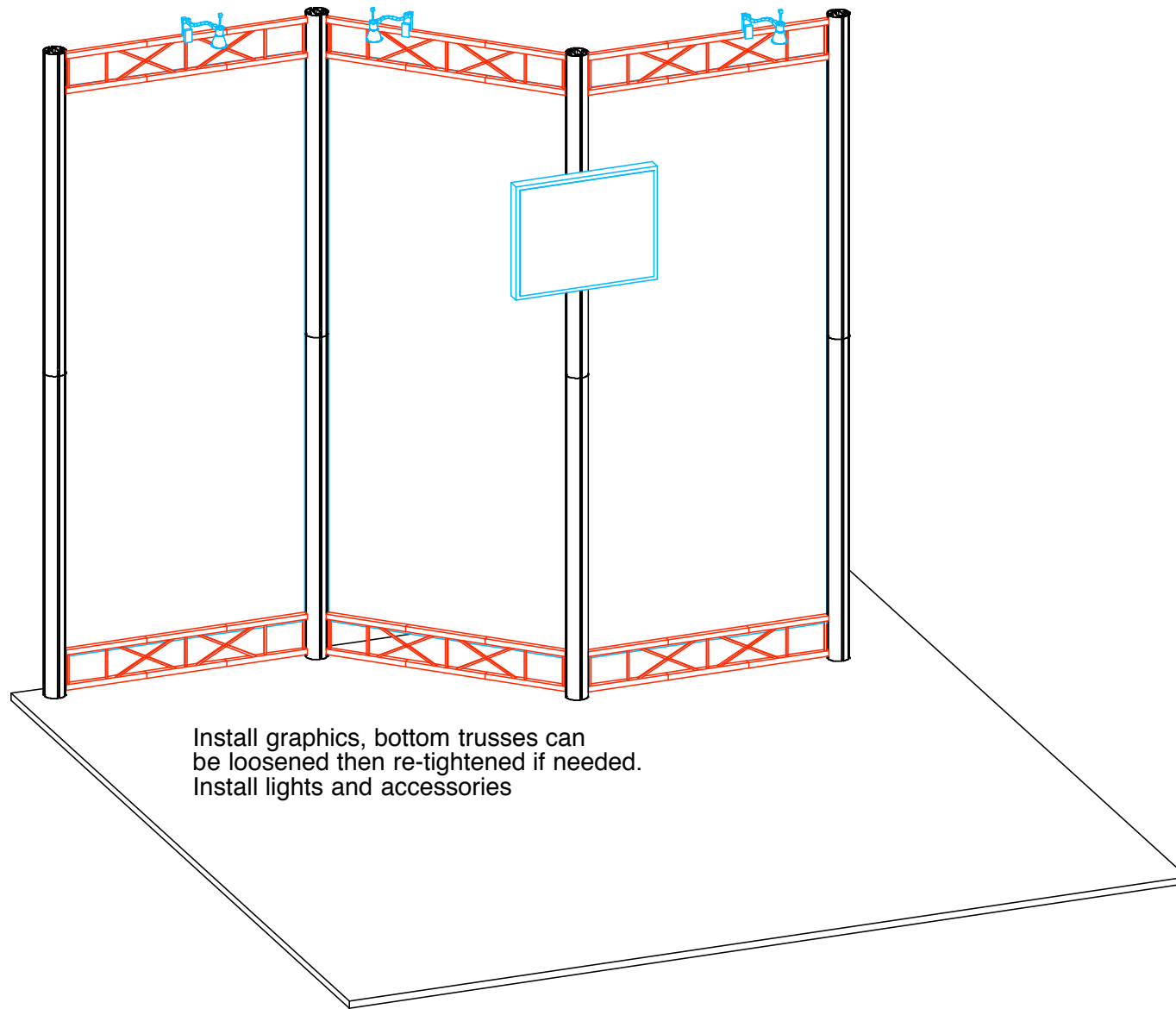

DESIGN :

DATE:

REFERENCE:

© Trussworks 2009

The designs shown herein are the proprietary property of Trussworks and protected by copyright and other laws. This document is to be maintained in confidence. No portion of the information or design shown herein may be reproduced, electronically or otherwise, nor may any display be made from this design without written consent from Trussworks.

DRAWN BY: C.J.Morita