

Stand the 2 side units
apart as shown

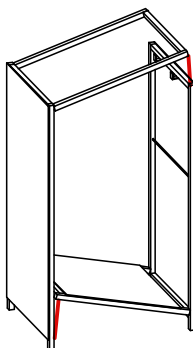

Swivel the cross braces into
place and secure them as shown

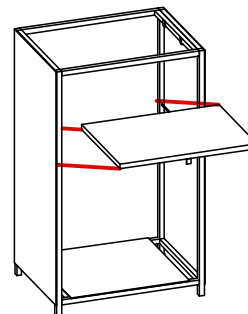

Insert the shelf

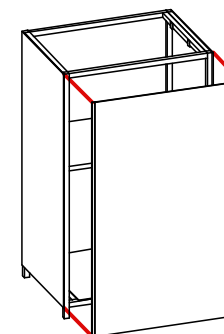

Attach the rear panel to
the back side of the counter
(the side with the velcro strips
top & bottom)

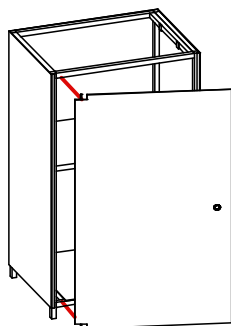

The door has pins located
top and bottom, the pin on top
is longer than the bottom one,
to install tilt the door and insert the
top pin into the frame, then align
the bottom pin and gently
lower the door into position.

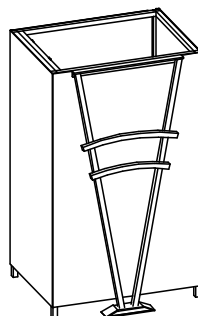

Apply front accessory trim
by standing it in front of
the counter and then
pressing the top edge with
the velcro against the front
of the counter

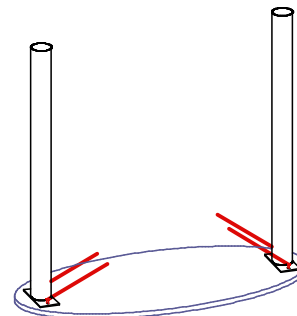

Place the counter top upside
down on a clean surface and
attach the leg posts by lining
up the holes in the as shown
and fastening in place with
4 wingnuts

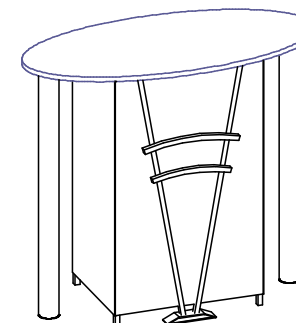

Carefully flip the counter top
over and place over the main
unit making sure to line up
the velcro strips on the
underside on the counter top

*Please note: Accessory trim and counter top shape may differ depending on
which model you purchased*



DESIGN :

DATE:

REFERENCE:

© Trussworks 2009

The designs shown herein are the proprietary property of Trussworks and protected by copyright and other laws. This document is to be maintained in confidence. No portion of the information or design shown herein may be reproduced, electronically or otherwise, nor may any display be made from this design without written consent from Trussworks.

DRAWN BY: C.J.Morita