

xpressions **SNAP!**

AVOID DAMAGE TO YOUR DISPLAY, USE PROPER SET-UP PROCEDURE.

Included on some 3x3 frames, some 10
quad pyramid frames, all 4x4,
4x3, and projector frames

autoXlock

with manual release



MANUALLY RELEASE THE YELLOW AUTO
LOCK ON EACH SIDE **BEFORE** BREAKING DOWN



for added set-up
security some
xpressions SNAP! kits
are equipped with 2 yellow auto X locks. Large
frames or heavily skinned kits benefit from the
self locking manual release clips

The auto X locks keep your large or heavily skinned display up and
stable. When it's time to break down your display **SIMPLY UNCLIP** both
connectors, then break down the frames as you would normally!

The auto X locks do not affect the Quick Set-up of your display, they simply lock by themselves.

Watch for snagged skins, before and during set-up



PLEASE READ CAREFULLY BEFORE SETTING UP YOUR DISPLAY!

xpressions**SNAP!**

AVOID DAMAGE TO YOUR DISPLAY, USE PROPER SET-UP PROCEDURE.

TWO PERSON SET.UP

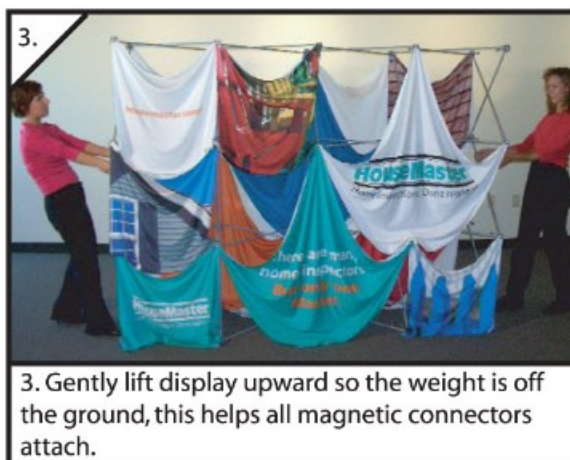
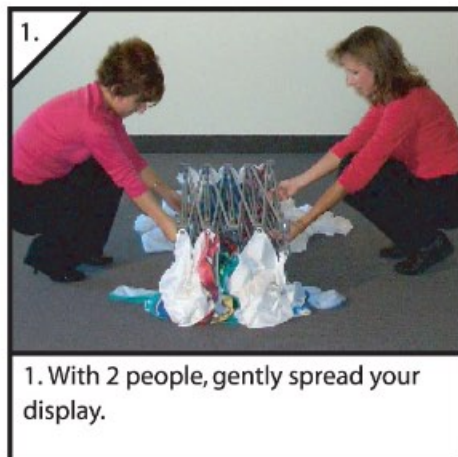

For More Information Visit www.xpressions-snap.com / help and support / tutorials.

PLEASE READ CAREFULLY BEFORE SETTING UP YOUR DISPLAY!

xpressions **SNAP!**

AVOID DAMAGE TO YOUR DISPLAY, USE PROPER SET-UP PROCEDURE.

ONE PERSON FLOOR SET.UP



1. Place frame on clean floor with front of graphic facing up. Make sure the skins are not tangled on the hubs!



2. Pull the frame outward to extend.



3. Press one side of the frame into the yellow autoXlock connector. Repeat on other side.



4. Pull the frame up and toward yourself from each side and that will connect the rest of the magnets.



5. Walk the display to an upright position.



6. **IMPORTANT** make sure to manually release the autoXlock before breaking down.

For More Information Visit www.xpressions-snap.com / help and support / tutorials.

PLEASE READ CAREFULLY BEFORE SETTING UP YOUR DISPLAY!

xpressions **SNAP!**

AVOID DAMAGE TO YOUR DISPLAY, USE PROPER SET-UP PROCEDURE.

ONE PERSON SET-UP, UNIT STANDING

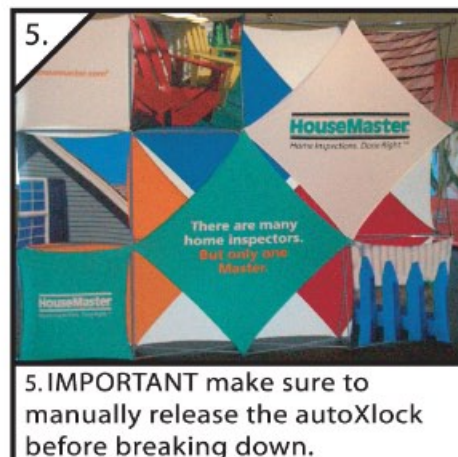
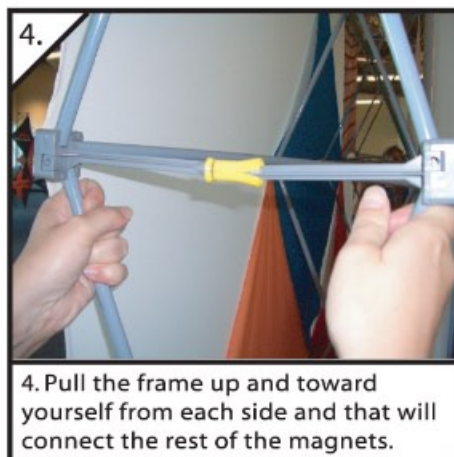
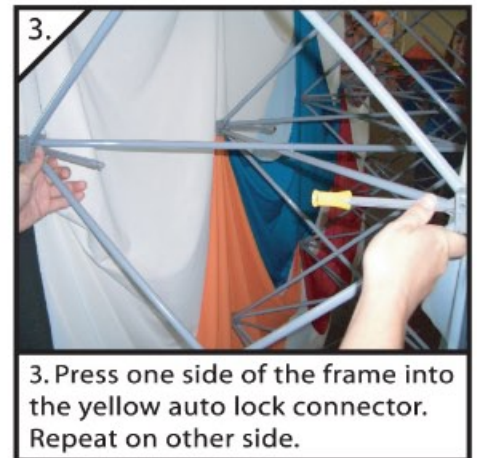
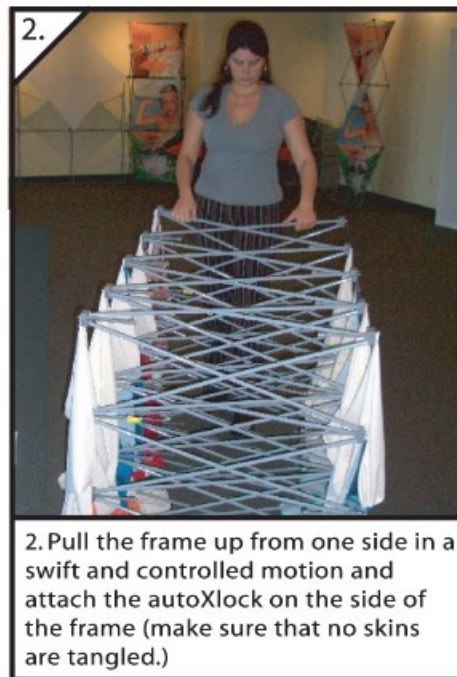
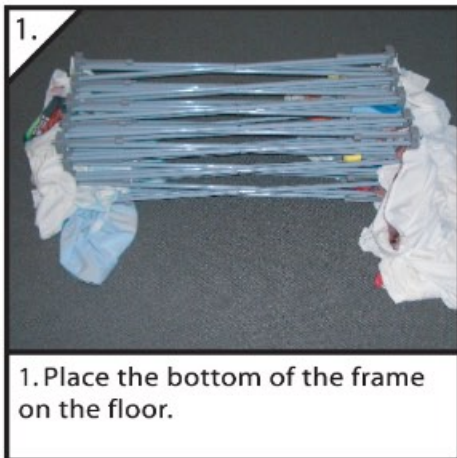

For More Information Visit [www.xpressions-snap.com / help and support / tutorials](http://www.xpressions-snap.com/help-and-support/tutorials).

PLEASE READ CAREFULLY BEFORE SETTING UP YOUR DISPLAY!

xpressions **SNAP!**

AVOID DAMAGE TO YOUR DISPLAY, USE PROPER SET-UP PROCEDURE.

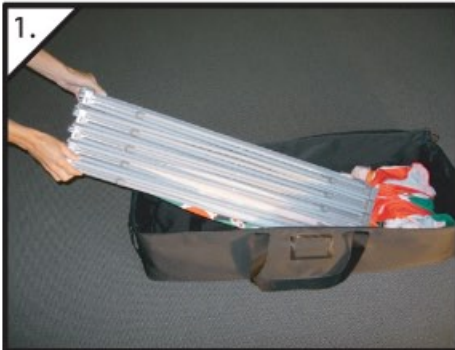

1. Unpack the display.

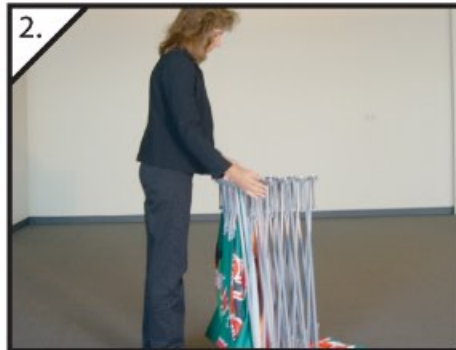

2. Place the frame on the floor - graphic side down; feet facing you.



3. Separate the frame slightly. Make sure graphics are not caught on frame or connectors.



4. Locate center hubs.



5. Reach in midway to grab the pole.



6. With an even and controlled motion, extend your arms up and out, until you hear the snap!



7. Enjoy your display!

For More Information Visit www.xpressions-snap.com / help and support / tutorials.



autoX lock

with manual release

for added set-up security some expressions SNAP! kits are equipped with 2 yellow auto X locks. Large frames or heavily skinned kits benefit from the self locking manual release clips



with 2 people gently spread your display



make sure skins are not snagged on magnetic connectors

The auto X locks do not effect the Quick Set-up of your display, they simply lock by themselves.



gently lift display upward so the weight is off the ground, this helps all magnetic connectors attach



auto X locks will connect on their own!

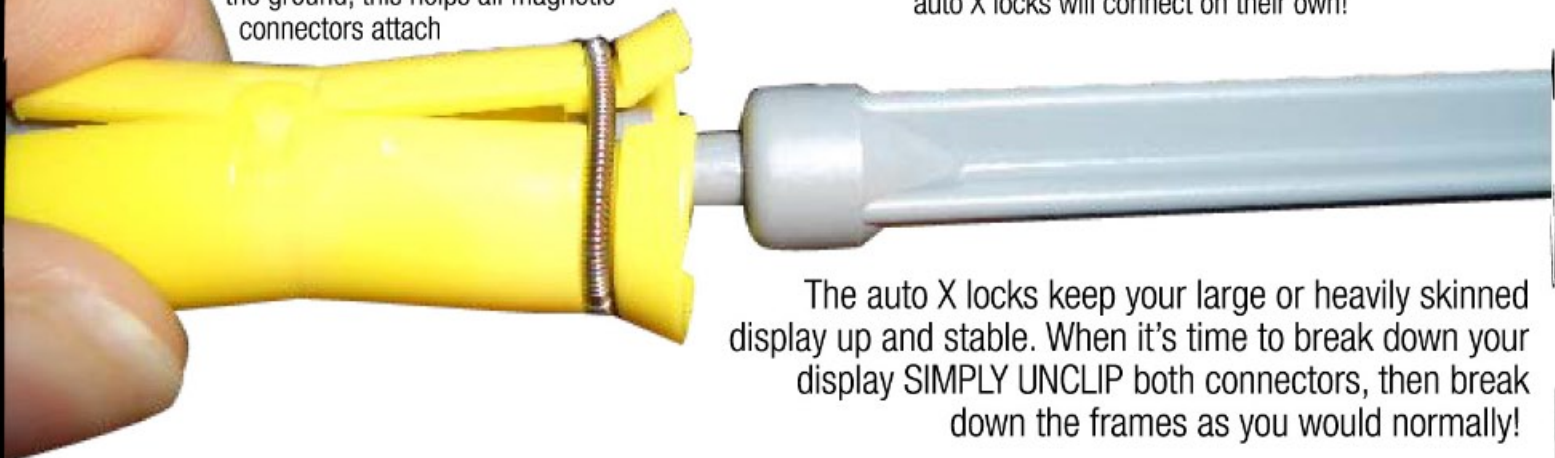

The auto X locks keep your large or heavily skinned display up and stable. When it's time to break down your display SIMPLY UNCLIP both connectors, then break down the frames as you would normally!

xpressions

Light Set Up information

Prepare Xpressions Light Kit

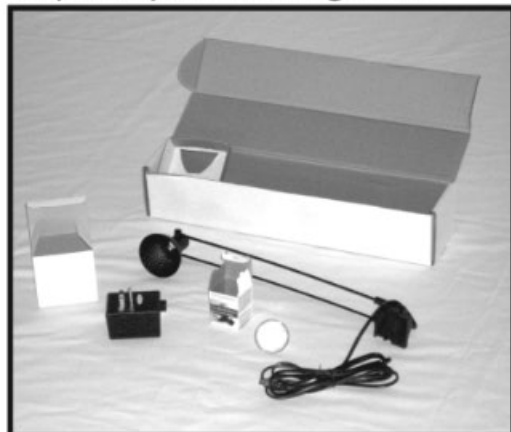

Xpressions Light Kit

Box includes: Light with attached gravity style base, bulb and power supply. note: power supply may vary from unit shown

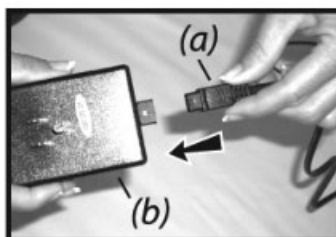

1. Connect the Light Electrical Cord (a) to Power Supply (b).
note: Power supply style may vary from unit shown.

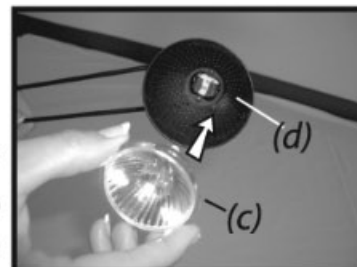

2. Place Light Bulb (c) into Light Socket (d)

Proper Xpressions Light Installation

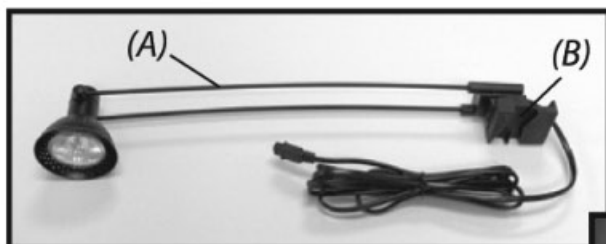

The Xpressions Light (A) uses a gravity style base (B) that fits within the scissor style frame bars (C) located at the top of each Xpressions frame quad.

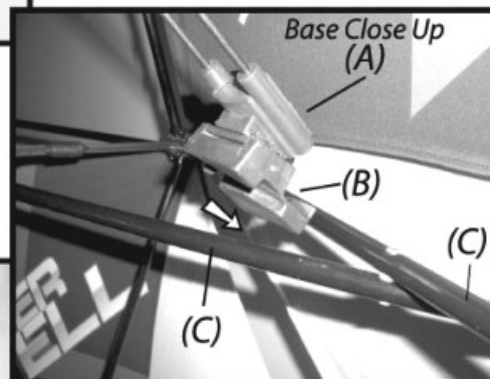

Tip Light (A) back as shown. Fit Base (B) between front and back Scissor Bars (C). Rest the Back of Base (B) under back Scissor Bar (C). Tip Light (A) downward resting the front of base on front Scissor Bar (C).

Xpressions SNAP! 5Quad X shown with light on top of middle quad.

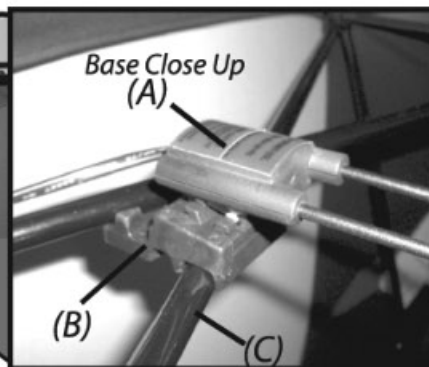
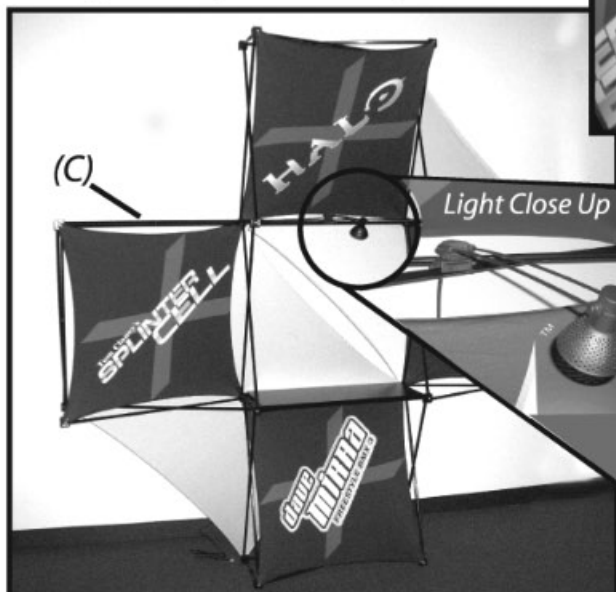

base of light shown resting correctly on the frame.