

Tower

TOW-S/B, TOW2-S/B

This cost effective, double sided, free standing tower features a sturdy construction and stylish design. The graphics are held under tension in a curved, eye-catching bubble position. Silver or black side extrusions are available and a backlighting kit is available to turn your tower into a lightbox.



features and benefits:

- Quick to set up
- Two widths available
- Lightbox conversion option
- Available in black or silver
- Large graphic display area

dimensions:

Hardware	Graphic
Assembled unit: TOW: 36" w x 17" d x 73.5" h	Visible dimensions: TOW: 33" w x 72" h
TOW2: 27" w x 17" d x 73.5" h	TOW2: 24" w x 72" h
Shipping	Refer to related graphic template for more information
Shipping dimensions - ships in three boxes	
TOW box 1, Bases: 37" l x 17" w x 3" h	
16lbs/7.3kg	
TOW box 2, Uprights: 40" l x 4" w x 3" h	
6lbs/2.8kg	
TOW box 2, Graphics: 15" l x 15" w x 34" h	
5lbs/2.3	
TOW2 box 1, Bases: 20" l x 3" w x 26" h	
14lbs/6.4	
TOW2 box 2, Uprights: 40" l x 4" w x 3" h	
6lbs/2.8kg	
TOW2 box 2, Graphics: 15" l x 15" w x 34" h	
5lbs/2.3	
Lighting Kit Box: 5" l x 5" w x 33" h	
33" Tower 66lbs/29.937 kg	
24" Tower 64lbs/29.03 kg	
	additional information:
	Graphic materials: .040" opaque styrene, .040 translucent PETG
	Flat head screwdriver needed for assembly
	Case upgrade: OCP
	
	OCP shipping dimensions - ships in one box 18" l x 26" w x 40" h
	Approximate shipping weight - case only 32lbs/14kg

Tower Assembly

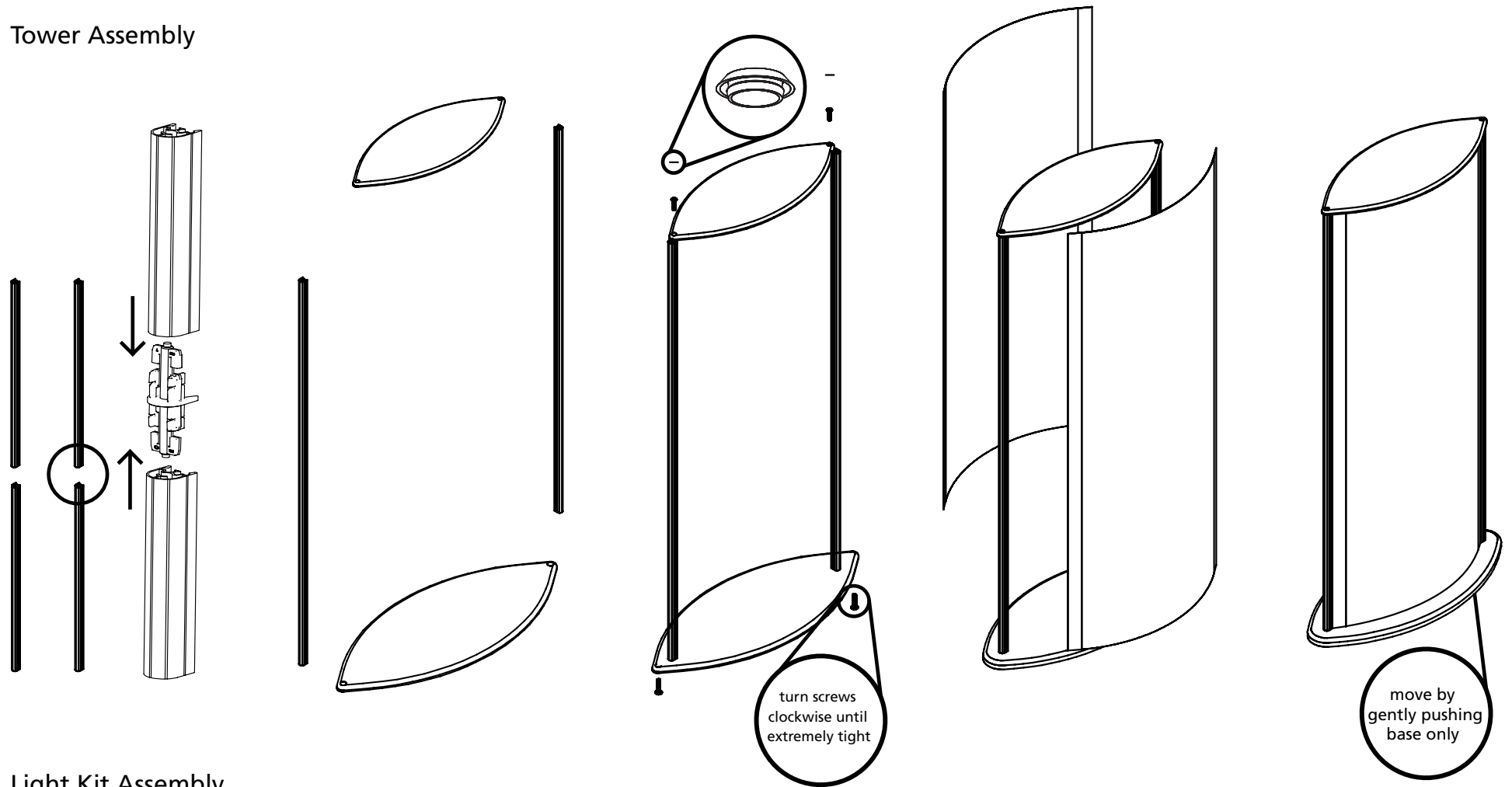

Light Kit Assembly

