

Shark Fin Banner

Pillowcase dye sublimation fabric combined with advance lightweight aluminum structures to provide unique design, functionality and style. Stretch fabric graphics are hand-sewn, durable and dry-cleanable.



We are continually improving and modifying our product range and reserve the right to vary the specifications without prior notice. All dimensions and weights quoted are approximate and we accept no responsibility for variance. E&OE. See Graphic Templates for graphic bleed specifications.

features and benefits:

- 30mm aluminum tube frame with snap button assembly
- Easy to store and ship
- Quick to set up
- Kit includes: one frame, dye-sublimated zipper pillowcase graphic, and one wheeled molded OCB storage case
- Lifetime hardware warranty against manufacturer defects

dimensions:

Hardware	Graphic
Assembled unit: 70"w x 86"h x 17.7"d 1778mm(w) x 2184mm(h) x 450mm(d) Approximate weight (includes graphic): 17 lbs / 7.7 kg	Total visual area: 70"w x 86"h 1778mm(w) x 2184mm(h) Please be sure to include 2" bleed around the perimeter. Refer to related graphic template for more information.
Shipping Shipping Dimensions: 1 OCB case: 47"l x 17"w x 7"h 1194mm(l) x 432mm(w) x 178mm(h) Approximate shipping weight (with case): 26 lbs / 11.8 kg	

additional information:

Graphic material:
Dye-sublimated zipper pillowcase fabric

*Double-sided option available



Parts Included

Part Label	Qty	Part Code
5MM STEEL BASE STYLE 2 FOR LINEAR	x2	LN114-S2
855MM X 30MM TUBE	x2	SHARK-T1
R3043MM X 30MM CURVED TUBE	x4	SHARK-T2
90 DEGREE ELBOW JOINT FOR 30MM TUBING WITH INSERT FOR BASEPLATE	x2	TC-30-90B
90 DEGREE ELBOW JOINT FOR 30MM TUBING	x1	TC-30-90
INLINE CONNECTOR FOR 30MM TUBING	x3	TC-30-S

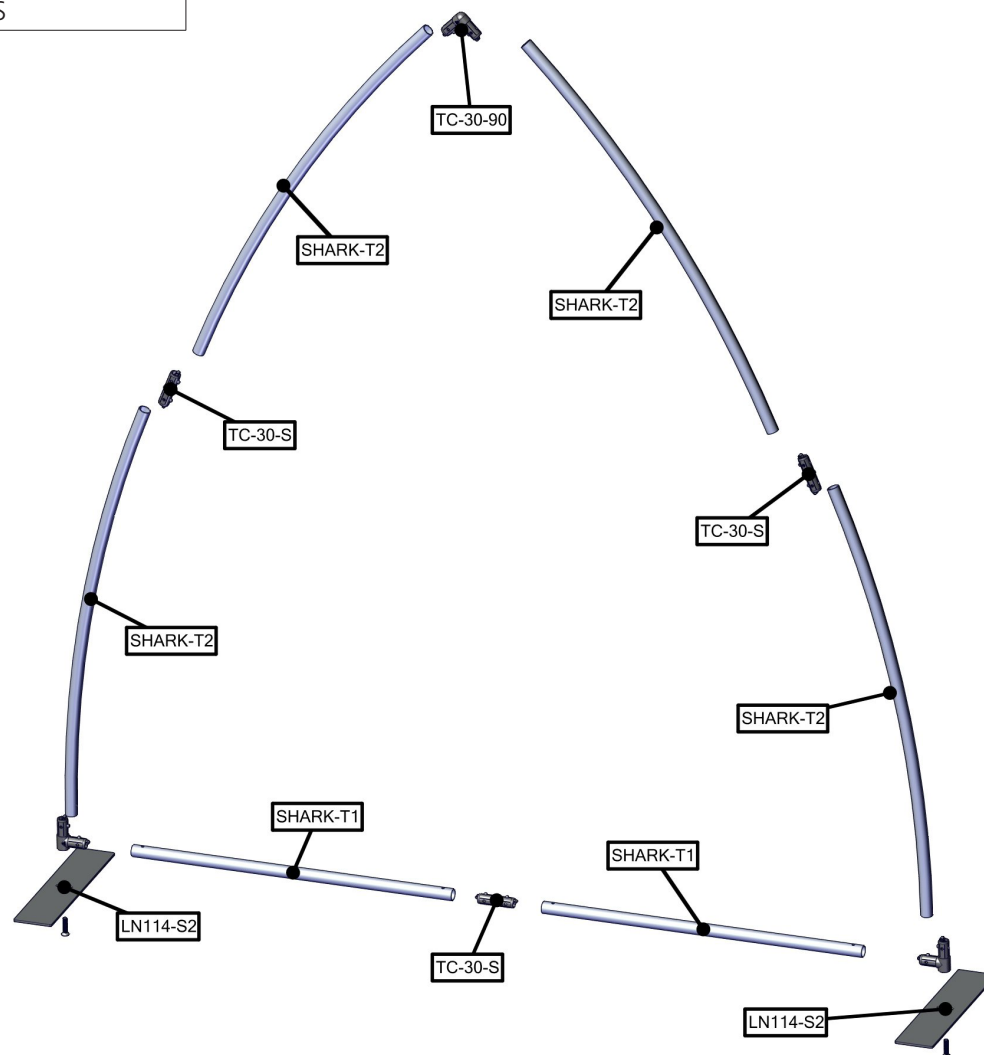
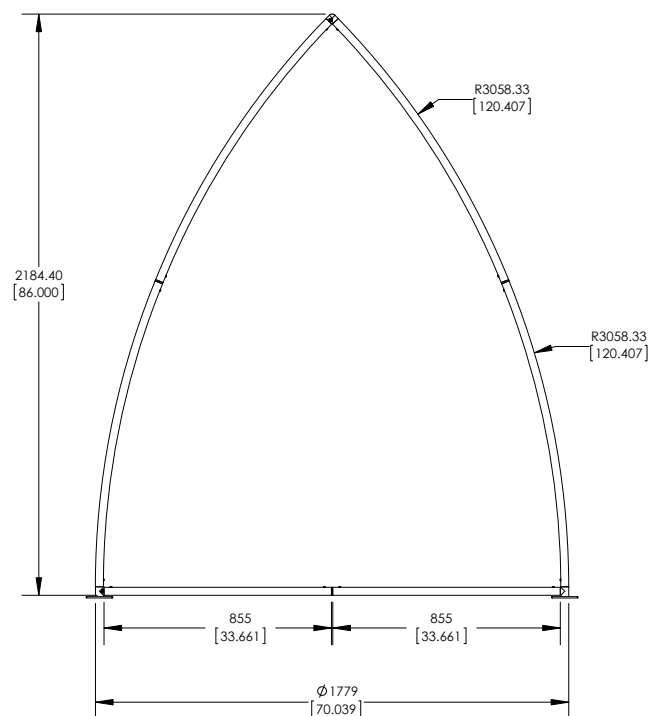
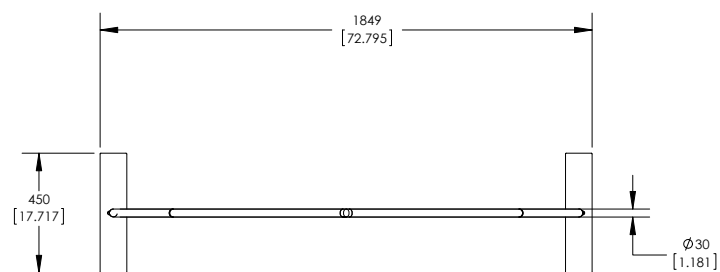

STEP 1: ASSEMBLE FRAME

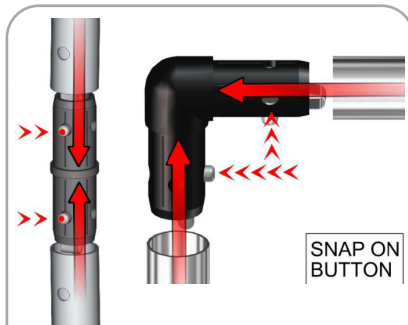

Assemble frame using TC-30-90 for corners and inline connector TC-30-S for sides of frame.

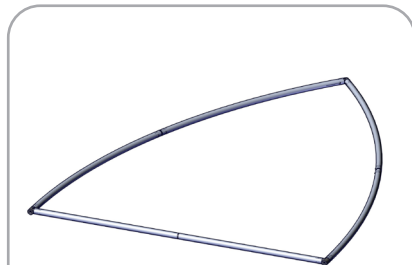

Label codes will be on backside of 30mm tubes. It is best to assemble frame laying flat.

STEP 2: ATTACH BASE

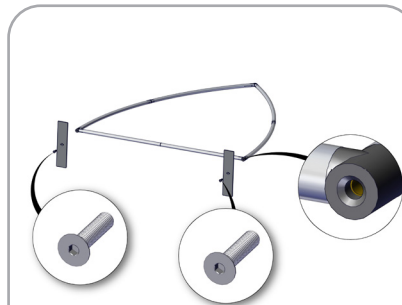

Attach feet to bottom of frame.

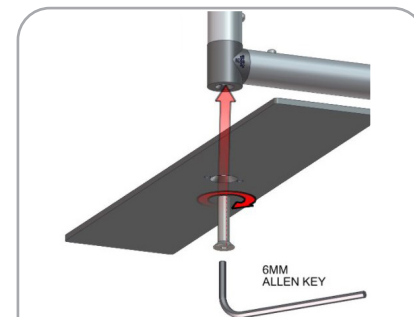

Attach feet base plates with 6mm Allen key as shown.

STEP 3: ATTACH GRAPHIC

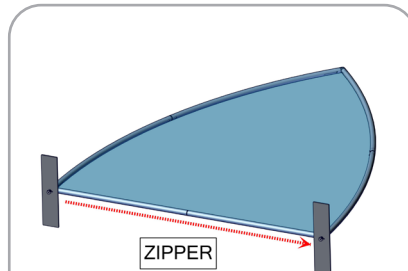

Pull fabric graphic over top of frame and zip along bottom to close.

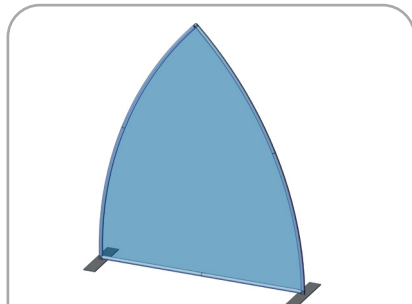

Stand unit upright.