

Product Parts for KIT

- 1 - Pallet (qty: 1)
- 2 - Angle U Hooks (qty: 2)
- 3 - Legs (qty:8)
- 4 - Fitted Throw (qty:2)

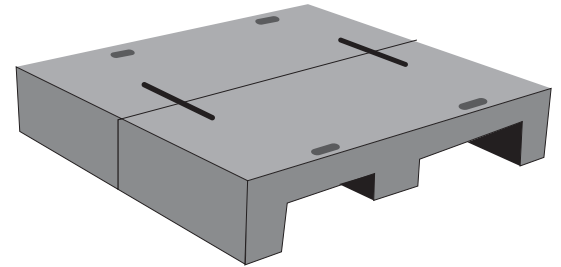
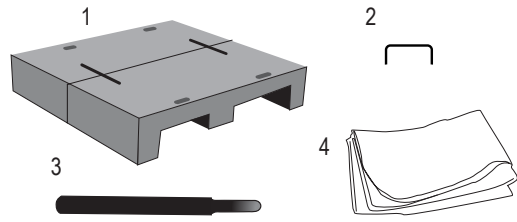

Display Set-Up

Step 1

Release the two-section Pallet (1) by removing both Angle U Hooks (2) from the holes nearest the "seam" of where the Pallet (1) sections meet. Store the Angle U Hooks in the holes away from the "seam".

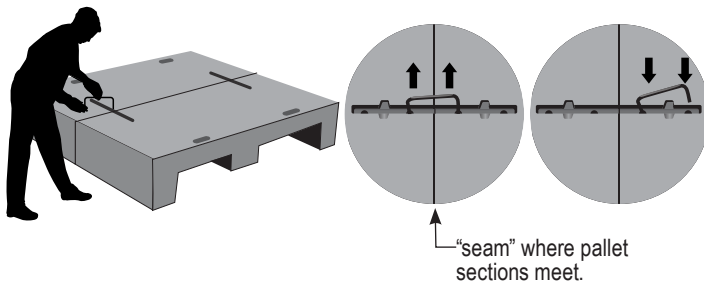

Step 2

Separate the 2 sections. You will now have access to the Legs (3).

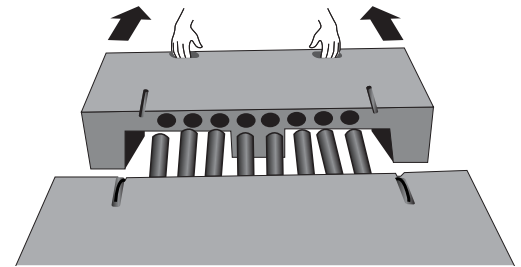

Step 3

Turn the Pallet (1) sections upside down. Push the Legs (3) (tapered end down) into the holes located at each corner.

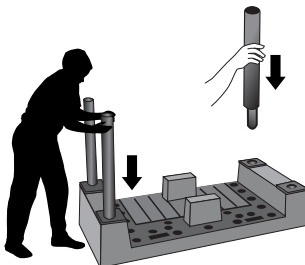

Step 4

The Pallet (1) now has become a table. Place it upright and cover it with the Fitted Throw (4)

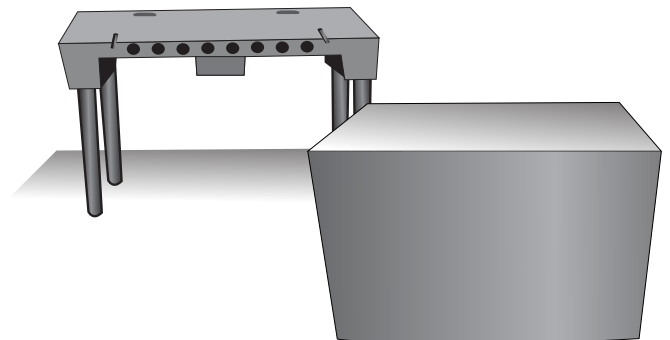

Step 1

Remove and fold up Fitted Throws (4). Turn both tables upside down.

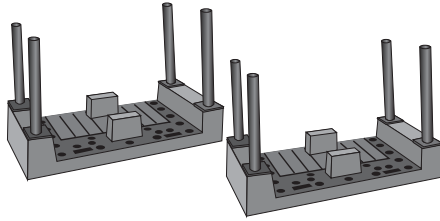

Step 2

Remove the legs from one table top. Flip it over.

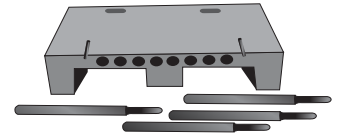

Step 3

Insert the (4) legs into the holes in the table top.

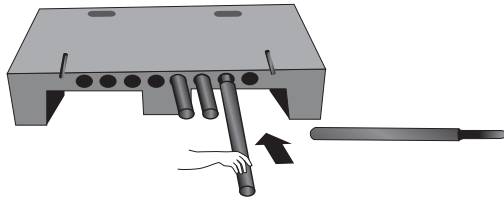

Step 4

Remove the legs from the other table top and insert them into the rest of the open holes.

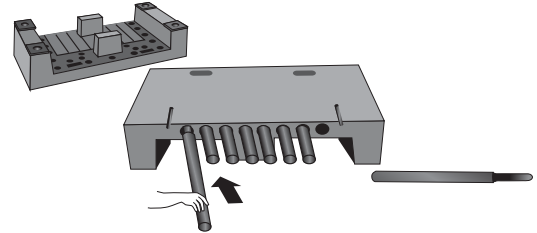

Step 5

With both table tops flipped over, slide them together aligning holes over the protruding legs.

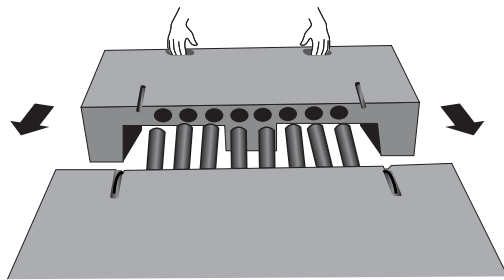

Step 6

Secure Pallet (1) by placing the Angle U Hooks (2) over the "seam" area.

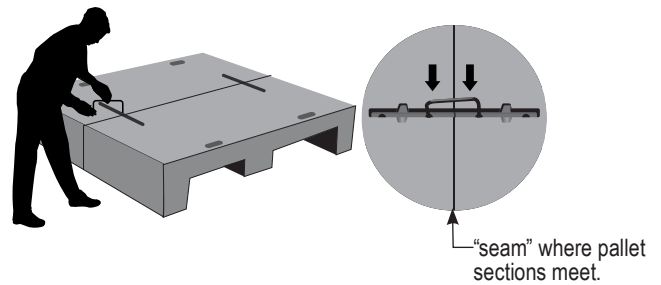

Step 7

Stack your supplies onto the Pallet (1200 pounds weight limit as a Pallet) and Shrink Wrap (not included) everything to the Pallet itself to secure.



Step 8

With products secured on Pallet you can now move everything by inserting the forks of a hand lift /fork lift into the slots.



Care

To clean Pallet, wipe with damp cloth. To clean Fitted Cover, Machine wash Cold Gentle Cycle. Machine Dry (Tumble Dry-No Heat). Do not dry clean. Steam out any wrinkles.

WARRANTY NOTE: 1 yr Structural Warranty does NOT cover Forklift or Re-Shipping Damage!

Warranty Information: All products are designed to provide the user with a cost-effective and durable product. Standard warranty is a 'one year parts and labor' warranty which warrants product against defects in material and workmanship. It does not cover damage due to accidents, abuse, or normal wear and tear. Products found to be defective will be replaced or repaired at factory's discretion.