

Contour Arc Banner Setup

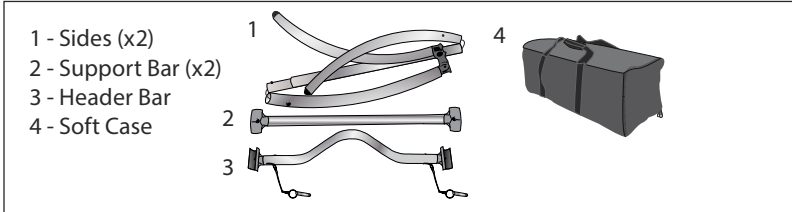

Item #	Product	Parts
254278 / 254287	KIT	Hardware and Graphic (parts 1-5)
254279 / 254288	Hardware	Hardware only (parts 1-4)
254280 / 254289	Graphic only	Graphic Only (part 5)

Product Parts for HARDWARE



Product Parts for FABRIC GRAPHIC (skip to STEP 7)

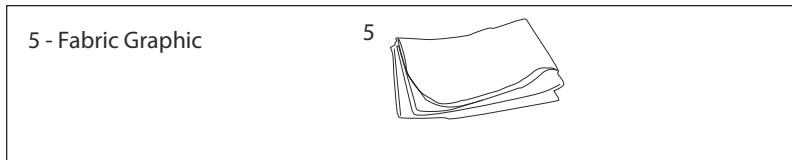

ALL PARTS COME IN THE KIT

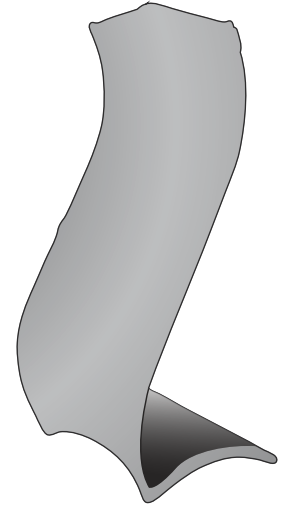

Display Set-Up

Step 1

Remove all parts from the case and place on a clean flat surface.

The Sides (1) are all connected. Bottom corner expands and pivots. All other joints are shock-corded.

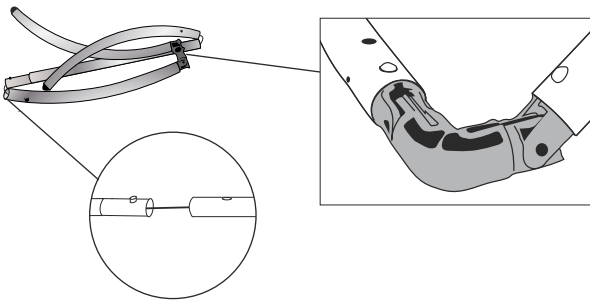

Step 2

Lock together both Sides (1) by pressing the snap release button and push each pole toward the corner.

Lock into place by releasing snap button when it lines up with the hole.

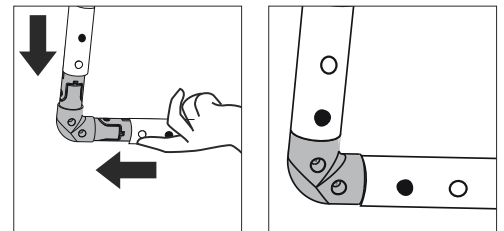

BOTTOM CORNER

Step 3

Secure shock-corded joints by inserting the tapered end of one pole into the large end of the next while pressing the button snap.

You should have two Sides (1) that look like this when complete:

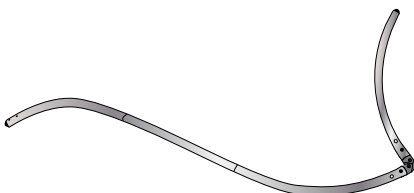
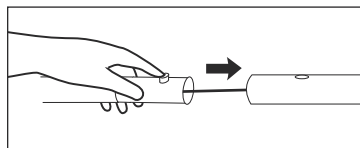

Step 4

Secure Sides (1) together with Header Bar (3) by snapping plastic ends over the metal frame of the Sides (1).

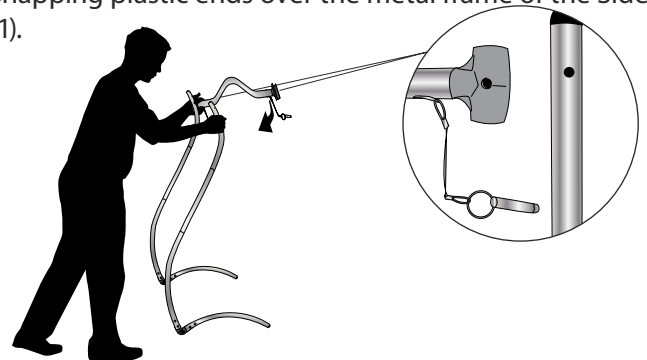

Display Set-Up Continued...

Step 5

Lock Header Bar (3) into place by inserting and pushing in the locking pin.

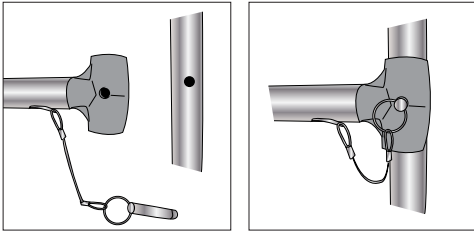

Step 7

Verify Frame is secure and that zipper at bottom of Fabric Graphic (5) is open. Slide Fabric Graphic (5) over framework and zipper closed at bottom.

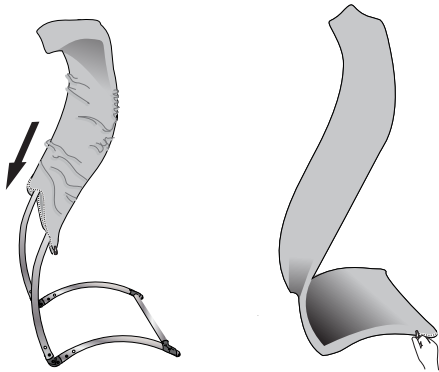

Step 6

Secure both Support Bars (2) to Frame by snapping plastic ends over the metal frame.

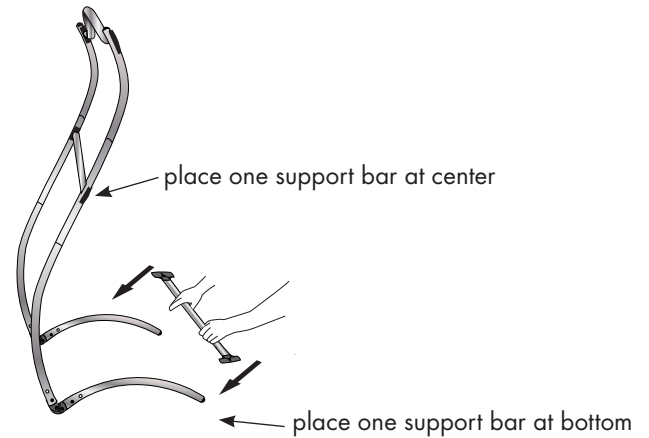

NOTE:

If back inside curve area looks puckered or baggy, reopen the end and push the bottom support bar closer toward the bottom corner.

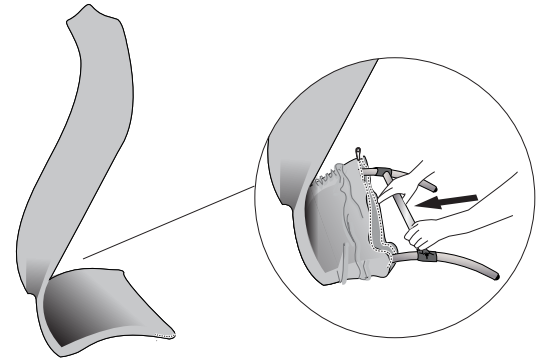

Storage

Reverse the steps for Disassembly and place all product parts into Soft Carry Case (4) and store in a cool dry location.



Care

Recommended for indoor use only.

Machine wash on gentle cycle using mild detergent. Line Dry. Do NOT dry clean, Do NOT Iron.