

MAST ASSEMBLY

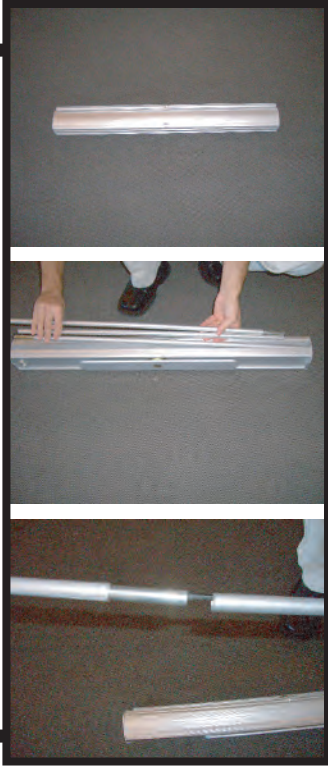

1. Remove Unit from Bag

2. Remove Mast From Unit

3. Assemble Mast. Simple Pole to Pole Connection with Bungee Cord Tension.

BANNER GRAPHIC ASSEMBLY



4. Place Mast Vertical in Unit. Mast Slides into Unit Hole and into an Internal Base Sleeve. Pole should be Perpendicular to the Floor / Unit.

5. Holding the Mast as High as possible, with one Hand while Grasping the Banner Top Hardware with the other...pull the retracted banner up slowly. Make sure graphic is not tracking off to the sides and scraping unit. If banner touches unit, retract slowly and start over. Lean the Unit toward you at an angle if this helps with the height.

6. Attach Small Steel Clip into Mast.



FOOT ASSEMBLY

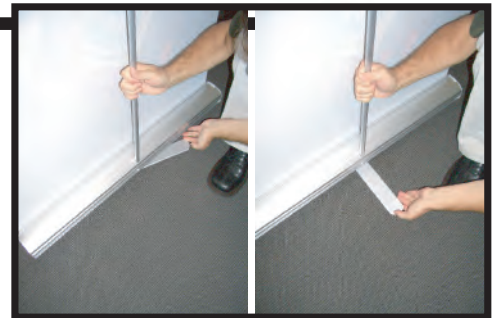

7. Slide Foot at Bottom of Base out as shown above Unit will Stand Straight.

BREAK DOWN IMPORTANT!

Avoid Damage To Your Pronto!

1. Unhook small steel clip. continue to hold top of banner.
2. Use mast as a guide and slide your hand slowly down the mast, making sure graphic is retracting straight into the unit.
3. Do not allow graphic to wander and touch the edge of the unit.
4. If the banner starts to wander STOP and pull slowly upward.
5. Begin Retracting again.

6. Carefully Slide Unit Back Into Padded Bag. NEVER DROP UNIT INTO BAG! HARD IMPACT TO THE SIDE OF UNIT WILL CAUSE DAMAGE!